

**Secura Lath®**

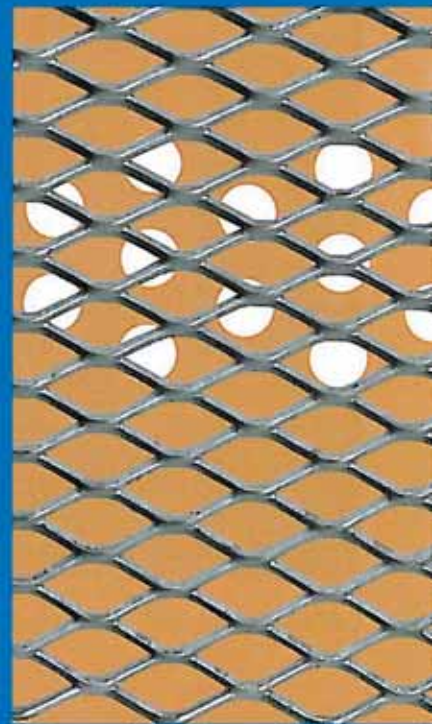

# SECURA LATH®

## Product Name

AMICO Secura Lath®

## Manufacturer

Alabama Metal Industries Corporation  
3245 Fayette Avenue  
Birmingham, AL 35208  
Phone: (205) 787-2611  
(800) 366-2642  
Fax: (205) 786-6527

## Product Description

AMICO Secura Lath (ASL) is fabricated from steel that is expanded to form a diamond pattern, much like that of diamond mesh lath. Secura Lath is formed from 16 gage carbon steel which, when plastered with portland cement or high strength gypsum plaster, provides a superior barrier to penetration. AMICO Secura Lath sheets are 27" x 97" and have one-sided, vinyl-coated perforated kraft paper attached, to aid in curing. This paper also offers resistance and therefore affords better keying and economy of plaster. Secura Lath is furnished with a pre-galvanized finish. Secura Lath is made from one sheet of steel, and will not unravel when cut. It requires many single cuts and much time to cut a hole large enough for escape. Further complicating the escape attempt, are sharp pointed hooks that remain exposed when Secura Lath is cut.

## Basic Use

Secura Lath is used primarily in the ceilings where there is a need to prevent access or escape from one area to another. Secura Lath is ideal for ceiling applications in prisons, courtrooms or jail holding cells, juvenile facilities, and psychiatric institutions. It is not limited to only these types of projects.

AMICO Secura Lath is a patented product developed, produced and sold by Alabama Metal Industries Corporation.



AMICO Secura Lath is made from one sheet of steel that cannot unravel when cut. Combined with the element of surprise, Secura Lath provides a superior penetration barrier when used as the substrate for plaster and stucco.

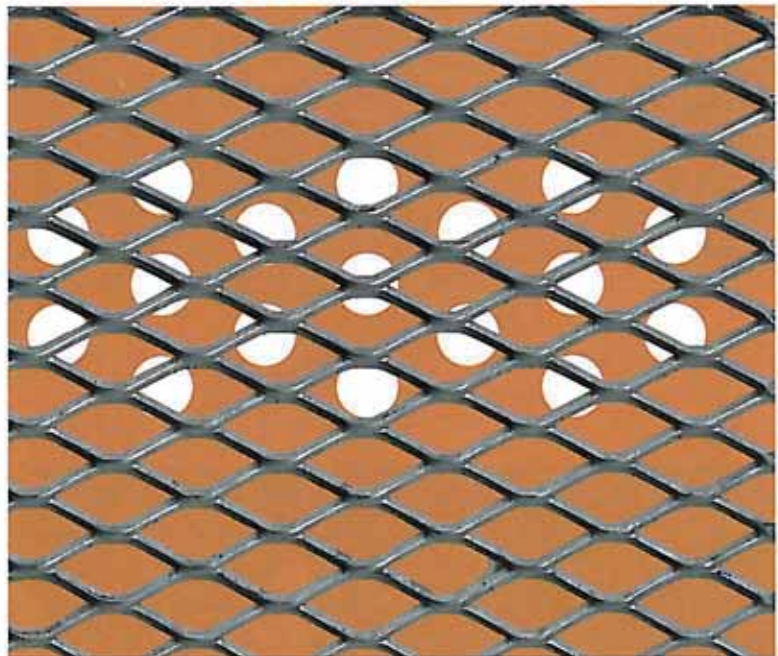

AMICO Secura Lath is produced with a pregalvanized finish. Perforated vinyl coated draft paper is attached to one side to aid in curing. This paper also permits better keying and conservation of the plaster.



For more information on our security products, visit [www.amico-securityproducts.com](http://www.amico-securityproducts.com) or call 800.366.2642.

# SECURA LATH®

## Packaging

Each sheet of AMICO Secura Lath measures 27" x 97" which equals 18.2 square feet per sheet with quantities supplied as required.

## Installation

### *Method of Cutting:*

Circular saw with either a carbide tip blade or metal abrasive blade, hand grinder, or commercial nipper are all recommended for cutting Secura Lath.

### *Methods of Attachment:*

AMICO Installation Guidelines for Secura Lath are available by contacting the Security Products Technical Services Department in Birmingham, Alabama. (Telephone: 800/366-2642)

## Installation Note

Secura Lath installs much the same way as diamond mesh lath. For this product to perform properly, the AMICO Installation Guidelines must be followed to the letter in order to obtain desired results and to keep cracking to a minimum. All stucco will crack to some degree due to shrinkage and movement. If the Installation Guideline is correctly followed, cracking should be kept to an acceptable level.

## Product Handling and Storage

Secura Lath should be protected from moisture during shipment and prior to installation and stored so as to prevent distortion of sheets.

## Technical Data

Secura Lath exceeds the requirements of ASTM C847, and ASTM C1063 and is fabricated from 16 gage carbon steel which meets ASTM A 1011.

Available in pregalvanized steel with perforated kraft paper to allow wire tying to ceiling supports. The kraft paper is also vinyl coated on one side to aid in the economy of plaster used.



Use AMICO X-66 galvanized steel casing bead to secure the perimeter edge while allowing for movement.



Secura Lath is easily cut using abrasive blade, carbide tip blade or hand grinder.

# SECURA LATH SPECIFICATION

## PART 1 - GENERAL

### 1.01 DESCRIPTION OF WORK

Included work not limited to the supply and installation of a complete in place security lath structural base for Portland cement stucco or high strength gypsum plaster and all complimentary accessories.

### 1.02 SUBMITTALS

Product Data: Submit manufacturers literature and Secura Lath Installation Guidelines for Walls and Ceilings.

### 1.03 QUALITY ASSURANCE

The contractor must have adequate experience with the construction methods involved with plaster and stucco installations.

### 1.04 REFERENCES

Secura Lath exceeds the requirements of ASTM C847 and ASTM C1063. Secura Lath is not specifically covered by current ASTM Lath specifications, but due to its weight and strength it exceeds current metal lath specifications. General requirements for steel - ASTM A1011 and EMMA 557-99. Underwriters Laboratories Rated Assemblies will not be jeopardized by using ASL mesh in the fire rated assemble. (U/L Subject File #1857)

### 1.05 STORAGE AND HANDLING

Materials shall be stored in such a manner to ensure proper ventilation, and drainage and to protect against damage from weather, vandalism, and theft. In event of freight damage, note freight bill and contact manufacturer immediately.

## PART 2 - PRODUCTS

### 2.01 MANUFACTURER

Physical penetration barrier shall conform to ASL .50-16R as manufactured by Alabama Metal Industries Corporation (AMICO), Birmingham, AL. Attention Security Products Department: Telephone 800/366-2642

### 2.02 MATERIALS

A. The security lathing system shall comply with AMICO ASL Secura Lath as manufactured by Alabama Metal Industries Corporation.  
B. Perforated kraft paper that is vinyl coated one side shall be factory attached to the metal lathing. Perforations allow the wire tying of the steel lathing to the carrying channel and the vinyl-coated paper shall prevent the excessive and uneven application of plaster.

### 2.03 FINISH

A. Pre-Galvanized Finish - standard installations lathing mesh shall be pre-galvanized prior to expanding and the factory applied paper backing.

--OR--

AND BY MEETING SPECIAL MINIMUM REQUIREMENTS

B. Hot-Dip Galvanized Finish - for high moisture installations lathing mesh shall be hot-dip galvanized prior to expanding and the factory applied paper backing.

## PART 3 - EXECUTION

### INSTALLATION

3.01 Secura Lath physical penetration barrier must be installed to the letter per the AMICO Secura Lath Installation Guidelines to obtain desired results and to keep cracking to a minimum. All stucco cracks to some degree due to shrinkage and movement, however if the Installation Guidelines are followed, cracking should be kept to an acceptable level.

The Installation Guidelines procedures follow ASTM Current Standards C1063, ASTM C841, ASTM C926, ML/SFA 920 and in some instances have exceeded these specs due to the uniqueness of this system and for security requirements.

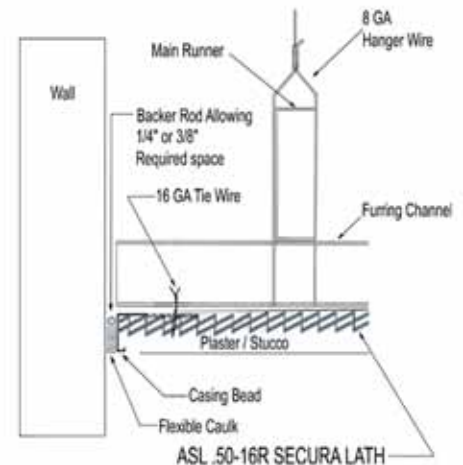

DESCRIPTION	FINISH	SHEET SIZE
ASL .50-16R	Pre-Galvanized and Paper Backed	27" X 97"
ASL .50-16R	Hot-Dip Galvanized and Paper Backed	27" X 97"

Ceiling and wall installation details are available in the AMICO Installation Guidelines publication.

QUALITY PRODUCTS - COAST TO COAST



A GIBRALTAR INDUSTRIES COMPANY

## ALABAMA METAL INDUSTRIES CORPORATION

3245 Fayette Avenue • Birmingham, AL 35208

Phone (205) 787-2611 • (800) 366-2642

Fax (205) 786-6527

[www.amico-securityproducts.com](http://www.amico-securityproducts.com)

see us at  
**Sweets**.com